

Bottle Cooler Range

Model: BC1, BC2 & BC3 - Datasheet

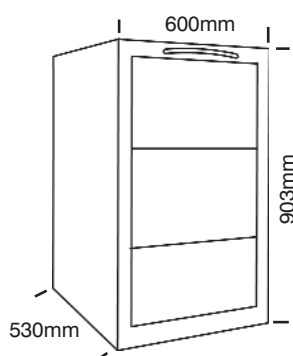

BC1

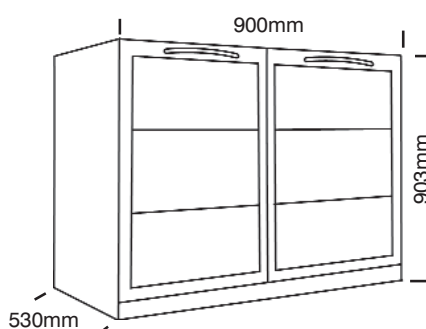

BC2

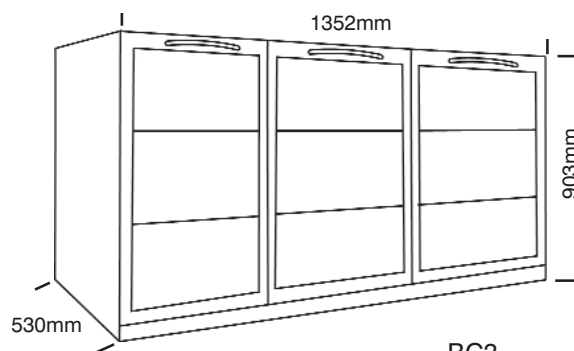

BC3

Key Features

- Choice of exterior finishes - black PVC coated galvanised steel or stainless steel
- Hard wearing exterior with hygienic, easy to clean mirrored stainless steel interior
- CoolSmart controller is designed for easy operation and features clear digital display
- Designed and engineered to operate efficiently up to a 32°C ambient, this exceeds Climate Class 4
- Precision injected, high density 35mm polyurethane insulation. Provides excellent thermal efficiency with low GWP (Global Warming Potential) and zero ODP (Ozone Depletion Potential)
- Castors to rear, adjustable feet to front for cabinet stability
- Barrel locked doors for added security

- Double glazed doors and bright, low energy consumption lighting for excellent display and presentation
- Fully adjustable nylon coated wire shelves to suit stacking requirements and accommodate vertical stacking capacity of three levels of 10" bottles
- Can be connected to a Williams temperature monitoring TAB system

Variant	Temp	Storage
BC1	+4/+10°C	Refrigerated
BC2	+4/+10°C	Refrigerated
BC3	+4/+10°C	Refrigerated

Options

- Solid doors (available in stainless steel and black finish)
- Aluminium interior available on black external finishes only
- Wine shelves

Dimensions

	BC1BS	BC1S3	BC2BS	BC2S3	BC3BS	BC3S3
External (mm):	H903 W600 D530	H903 W600 D530	H903 W900 D530	H903 W900 D530	H903 W1352 D530	H903 W1352 D530
Internal (mm):	H745 W530 D378 D253	H745 W530 D378 D253	H745 W377 D378 D253	H745 W377 D378 D253	H745 W377 D378 D253	H745 W377 D378 D253
Door Opening (mm):	D1130	D1130	D1130	D1130	D1130	D1130
Packed:	H905 W620 D550	H905 W620 D550	H905 W920 D550	H905 W920 D550	H905 W1452 D550	H905 W1452 D550
Weight: Add 5kg per product for packaging	58kg	58kg	86kg	86kg	116kg	116kg

Important Information

	BC1BS	BC1S3	BC2BS	BC2S3	BC3BS	BC3S3
Capacity: 330ml bottles	112	112	182	182	278	278
Construction						
Exterior	0.7mm black PVC galvanised steel	0.7mm stainless steel	0.7mm black PVC galvanised steel	0.7mm stainless steel	0.7mm black PVC galvanised steel	0.7mm stainless steel
Interior	0.7mm BA mirrored stainless steel	0.7mm BA mirrored stainless steel	0.7mm BA mirrored stainless steel	0.7mm BA mirrored stainless steel	0.7mm BA mirrored stainless steel	0.7mm BA mirrored stainless steel
Door	Double glazed with brushed aluminium surround	Double glazed with brushed aluminium surround	Double glazed with brushed aluminium surround	Double glazed with brushed aluminium surround	Double glazed with brushed aluminium surround	Double glazed with brushed aluminium surround
Power Supply	220V/240V 50Hz/1Ph 13 amp plug	220V/240V 50Hz/1Ph 13 amp plug	220V/240V 50Hz/1Ph 13 amp plug	220V/240V 50Hz/1Ph 13 amp plug	220V/240V 50Hz/1Ph 13 amp plug	220V/240V 50Hz/1Ph 13 amp plug
Power Input						
Start Up	8 amps	8 amps	8 amps	8 amps	10.3 amps	10.3 amps
Running	1.75 amps	1.75 amps	2 amps	2 amps	2.4 amps	2.4 amps
Compressor HP	1/5	1/5	1/5	1/5	1/4	1/4
Energy Consumption (Tested to EN153) in 24hrs	2.8kW	2.8kW	3.2kW	3.2kW	6.8kW	6.8kW
Heat Rejection (Evaporating at -10°C in 32°C ambient)	330 watts	330 watts	330 watts	330 watts	565 watts	565 watts
Refrigerant	R134a	R134a	R134a	R134a	R134a	R134a
Defrost	Auto defrost and evaporation	Auto defrost and evaporation	Auto defrost and evaporation	Auto defrost and evaporation	Auto defrost and evaporation	Auto defrost and evaporation
Insulation ODP Zero Polyurethane	35mm	35mm	35mm	35mm	35mm	35mm
Fittings Shelves (Nylon Coated Wire)	2	2	2	2	6	6



Bryggen Road, North Lynn Industrial Estate
King's Lynn, Norfolk PE30 2HZ

T +44 (0) 1553 817000

F +44 (0) 1553 817111

Spares +44 (0)1553 817017

E info@williams-refrigeration.co.uk

W www.williams-refrigeration.com

All refrigeration equipment requires adequate ventilation for efficient and effective performance. Williams are committed to a policy continuing product development and innovation and as such, we reserve the right to change product specifications stated without prior notice.

V5 - July 2010